

CUSTOMER PART No.

CUSTOMER

CAN ART STD.

DIE No.

EH05617

DESCRIPTION

2" x 4" x .120" WALL RECT. TUBE

PROPOSAL No.

H-7971

NOTE: BREAK ALL CORNERS WITH 0.015" (.38 MM) RADIUS UNLESS OTHERWISE NOTED. STANDARD TOLERANCES TO APPLY UNLESS OTHERWISE SPECIFIED.

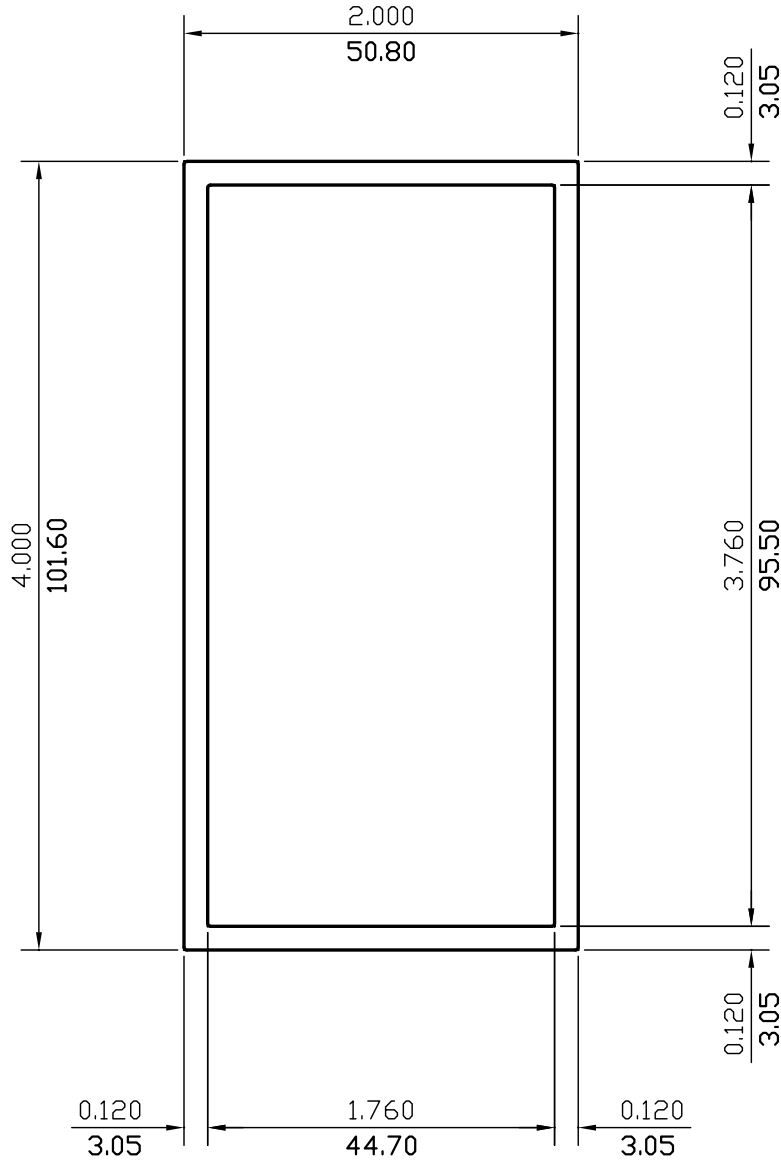

WALL THICKNESS **0.120 (3.05)** EXCEPT AS SHOWN

DATE	REV	DESCRIPTION	BY			
03/14/23	2	REMOVED ALLOY	JASON			
09/26/00	1	UPDATED DRAWING	P.M.			
EST.AREA	1.382	IN. ²	EST.AREA	891.876	MM. ²	
EST.WT.	1.631	LBS/FT.	EST.WT.	2.428	KG/M.	
EST.PER.	22.988	IN.	EST.PER.	583.908	MM.	
OUT PER.	11.974	IN.	OUT PER.	304.1	MM.	
C.C.D.	4.459	IN.	C.C.D.	113.254	MM.	
FACTOR	14	FINISH	M/F	ALLOY & TEMP.		
CKD BY	SCALE	1:1	DWN BY	C.P.	DATE	08/25/98

CAN ART

ALUMINUM EXTRUSION INC.

85 PARKSHORE DRIVE
BRAMPTON, ONT L6T 5M1
TEL. NO. (905) 791-1464
FAX NO. (905) 791-9151
E-MAIL: canart@canart.com

THIS DRAWING IS NOT NECESSARILY A COPY OF YOUR ORIGINAL. PLEASE APPROVE DIMENSIONS AND TOLERANCES INDICATED. CAN ART ASSUMES NO RESPONSIBILITY EITHER TECHNICAL OR LEGAL FOR HAVING THIS SHAPE MADE. THE CUSTOMER AGREES TO FULLY PROTECT CAN ART ALUMINUM FROM CLAIMS OF OTHERS RESULTING FROM THIS SHAPE.

SIGNED: _____ DATE: _____